



10/589 Stirling Highway Cottesloe WA



PROMINENT EXPOSUE & LOCATION

- ? 35sqm approx..
- ? Balcony
- ? 1 Carbay
- ? Price: From:\$18,000.00 + GST P/A + Outgoings
- ? Outgoings : \$7,000.00 + GST P/A.

Type : Offices
Building Size : 35 sqm
View : <https://www.abelproperty.com.au/8169822>



Tino Bruzese
08 9208 1999

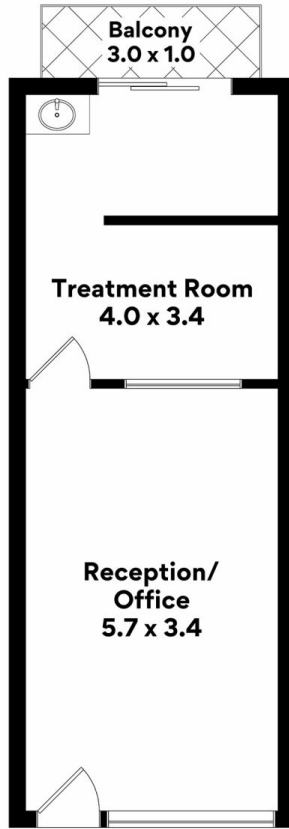

10/589 Stirling Hwy, Cottesloe

Whilst every attempt has been made to ensure the accuracy of the floorplans contained here, measurements of doors, windows and rooms are approximate and no responsibility is taken for any error, omission or mis-statement. These plans are for representation purposes only.