



## 24 Sholl Avenue North Beach WA

4 1 1

Sitting on a huge beachside approximately 200m from the ocean, this stunning coastal character home has been recently renovated. Four large bedrooms, one with it's own entrance & plumbing, perfect for use as a studio/home salon or teenagers retreat. Modern kitchen overlooking the yard. Large front porch where you can sit and watch the world go by. The lounge has a fireplace and sea views and family room with feature tiling. High ceilings giving the illusion of space. Renovated bathroom and laundry. Large undercover alfresco at the rear with outdoor kitchen, complete with plumbing and bbq. Plenty of lawn space for the kids and large lock up shed. Fabulous location, just a short stroll to all the restaurants, cafes and boutique shopping that Northbridge has to offer. Close to schools and North Beach Plaza shopping centre. Only 250m to Spinifex North Beach and 800m to Charles Riley Reserve. Sorry no pets.

**View :** <https://www.abelproperty.com.au/8053613>



**Debi Segetin**  
**08 9208 1999**

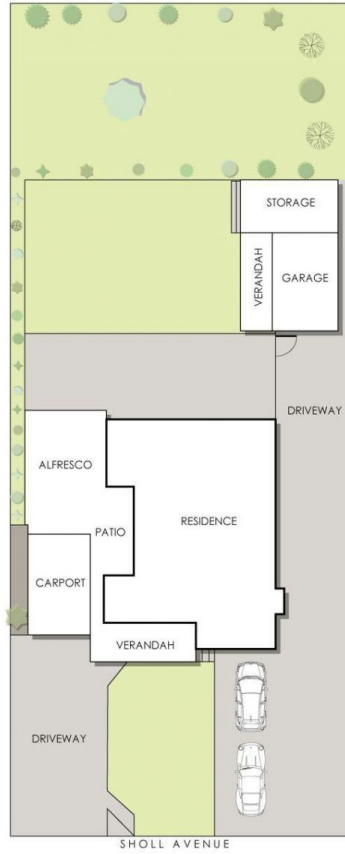
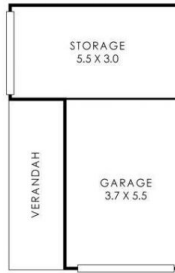

**24 Sholl Avenue, North Beach**

Residence 112m<sup>2</sup> Carport 20m<sup>2</sup> Garage 37m<sup>2</sup> Verandah 23m<sup>2</sup> Alfresco 33m<sup>2</sup> Patio 12m<sup>2</sup>

**Total Area 237m<sup>2</sup>**



This floorplan is for illustrative purposes only. It is not intended to be used as a contract or to show any specific features or details. The floorplan is shown as an approximate representation and is not to scale. It is not intended to be used as a contract or to show any specific features or details. The floorplan is shown as an approximate representation and is not to scale. It is not intended to be used as a contract or to show any specific features or details. The floorplan is shown as an approximate representation and is not to scale. It is not intended to be used as a contract or to show any specific features or details.