



4 Melview Court Melville WA

5 2 2

YOUR HOME

Positioned in a whisper quiet cul-de-sac street, this large, single level family home has ample accommodation, a fantastic layout and wonderful potential. Situated on a large, elevated block of 860m² with substantial frontage, this expansive property provides a myriad of options to any astute buyer. The block is also possibly subdivisible, subject to approval from the relevant authorities.

Boasting an attractive floor plan, this endearing home has five spacious bedrooms, including a master bedroom with his and hers walk through robe and en-suite. There are multiple generous living areas allowing great separation if required, with other features include high ceilings, ducted evaporative air conditioning (cooling), and good natural light throughout much of the home.

Land Size : 860 sqm

View : <https://www.abelproperty.com.au/8036914>



Cam McGregor
08 9208 1999

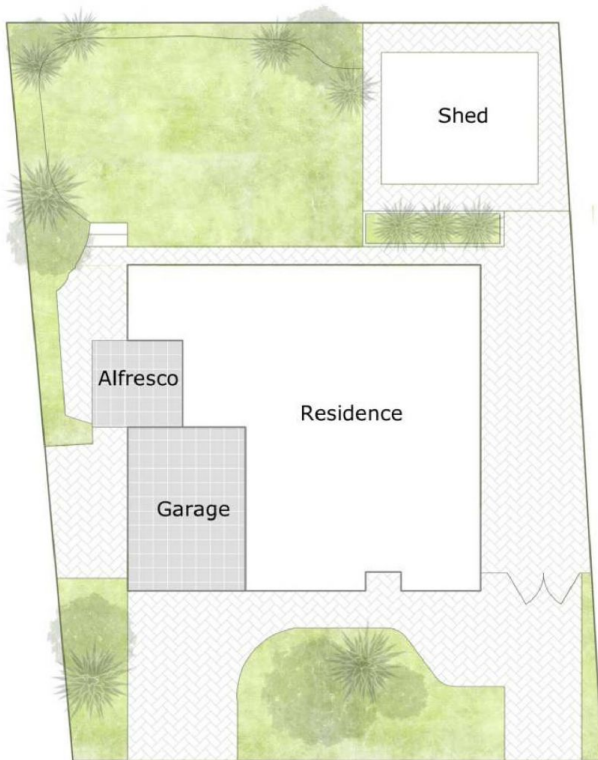

Approximate Areas:

Residence 223 m²
 Alfresco 19 m²
 Garage 40 m²

Total 282 m²



4 Melview Court, Melville, WA 6156

Care has been taken to ensure the accuracy of this floor/site plan, however all dimensions and areas should be considered as approximate. It has been produced as a guide for the purpose of the property sale or lease only. No credit is taken for the original building or landscape design. This floor plan/site plan design is subject to strict copyright and should not be reproduced, copied or altered without prior consent. The Agent, Vendor & Finesse Photography will not be held liable or responsible for any error, omission, misstatement or use of any data shown on this plan.