



7/3 Currie Street Jolimont WA

1 1 1

Ideal for first home buyers or investors, this stunningly situated 1x1 apartment is sure to impress.

Surrounded by beautiful parklands and luscious nature greens, this first floor apartment provides both convenience and connection.

Located in the tightly held suburb of Jolimont, experience the benefits of having amenities and facilities within easy walking distance. With Subiaco at your doorstep as well as both the CBD and coast only a few minutes drive away, this apartment is perfectly situated for all your needs.

With beautiful timber floorboards, plantation shutters, and a beautiful northern outlook, you will love the space this apartment offers, enough room to be comfortable but remain perfectly low maintenance and easy to keep in

[For full version visit the website](https://www.abelproperty.com.au/8005880)

Type : Apartment
Building Size : 47 sqm
Land Size : 67 sqm
View : <https://www.abelproperty.com.au/8005880>



Ryan Abel
 08 9208 1999

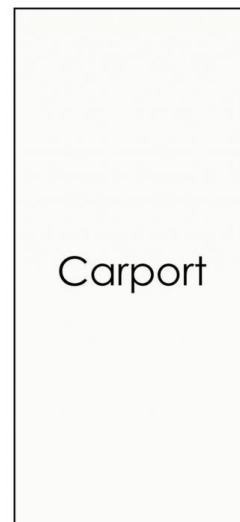
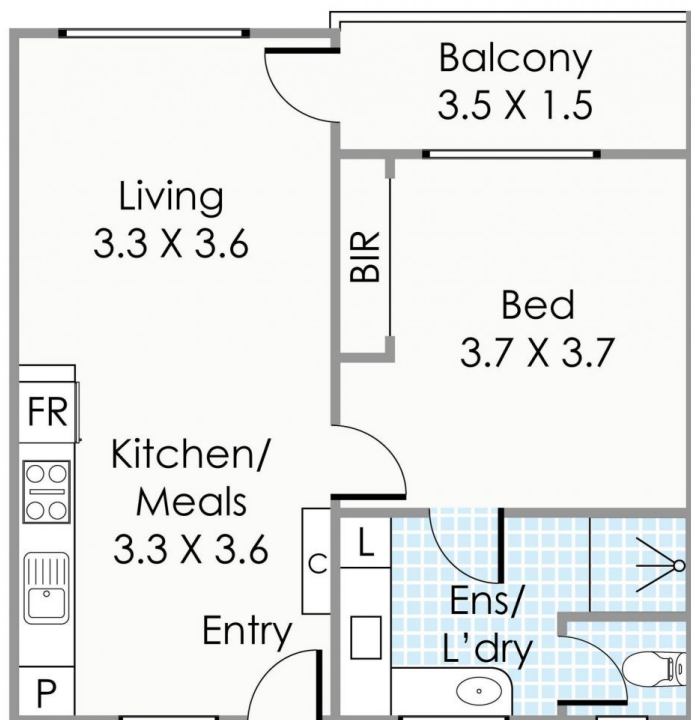

(Not Actual Location)

Approximate Areas

Residence:	47m ²
Balcony:	6m ²
Carport:	14m ²
Total Area:	67m ²

This floorplan is for illustration purposes only to show the layout of the property. Whilst every effort has been made to ensure the accuracy of this floor plan, all measurements, and any other information shown are an approximate interpretation only. Measurements and total areas do not include or account for wall thickness or roof area under eaves. Crib Creative will not be held liable or responsible for any error, omission, misrepresentation or use of any information shown on the final floor plan. Not to be used for any other purpose.
www.cribcreative.com.au



7/3 Currie Street, Jolimont