



3/52 Samson Street White Gum Valley WA

2 1 1

White Gum Villas

Welcome to contemporary design delivered in a convenient location only approximately 2 kilometres from Fremantle town centre and for the nature enthusiasts, within easy walking distance to the extensive natural parklands of Booyeembara or the budding golfer, the Fremantle Golf Club.

This Townhouse offers an excellent opportunity for those seeking an affordable Fremantle lifestyle, nestled amidst towering White Gum trees and just a brief stroll to Wray Avenue.

The home, freshly renovated throughout, comprises of two bedrooms, a stylish open plan living, dining and kitchen, separate laundry and is further enhanced with a rear

Building Size : 62 sqm
View : <https://www.abelproperty.com.au/8005861>



Kyle Peters
08 9208 1999



FIRST FLOOR

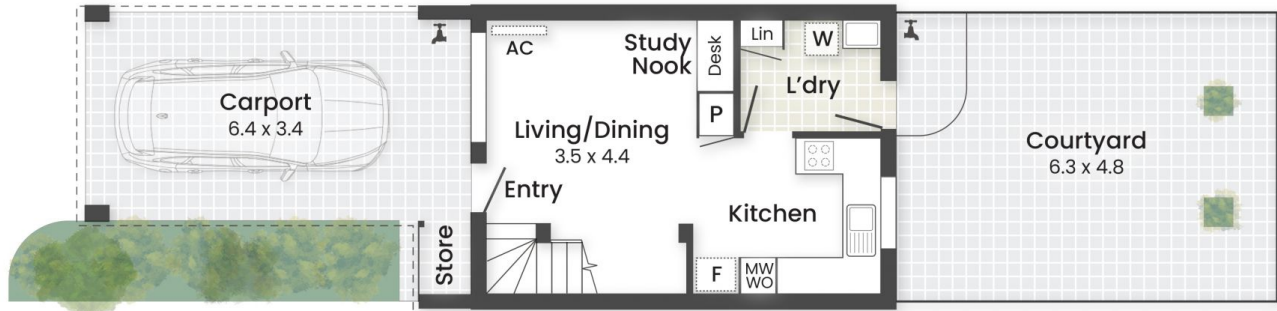
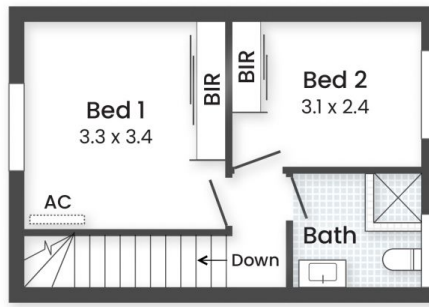

GROUND FLOOR

Strata Areas:	
Residence	62m ²
Other Areas:	
Caport	23m ²
Front Garden	8m ²
Courtyard	30m ²
Total	123m²