

94/96 Guildford Road Mount Lawley WA

2 1 1

Home Open cancelled Saturday 10 June - Please call to arrange an inspection.

Land Size : 95 sqm

View : <https://www.abelproperty.com.au/8005854>

Welcome to the Penthouse.

Located on the 9th floor of this well-established and maintained building, this beautiful top floor apartment provides enormous opportunity to the discerning buyer with truly amazing views of the Swan River, Perth CBD and all the way out to Perth's foothills.

These views can never be built out!

This home is secure, peaceful, and quiet, complementing all the conveniences and benefits of this unique riverside location.



Kyle Peters
08 9208 1999

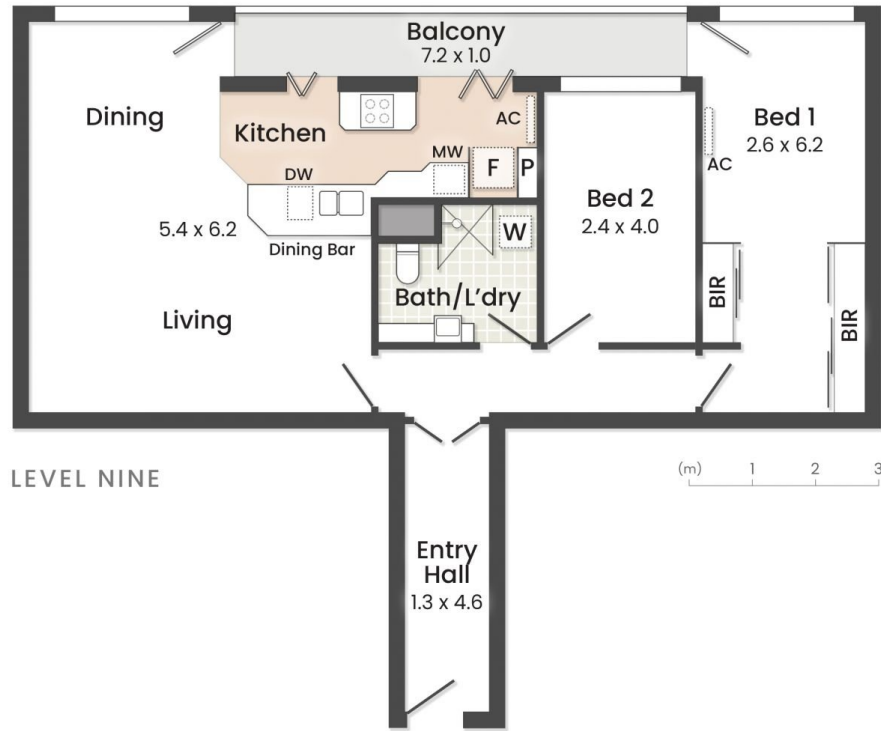

Total Strata Area 90m²