



11 Welford Street Aveley WA

4 2 4

Welcome to 11 Welford Street Aveley, a stunning immaculate property that will tick all of the boxes and more, designed for style and functionality this 'first time to market' property offers everything.

AT A GLANCE

4 bedroom, 2 bathroom (semi ensuite to minor bed), powder room, theatre, kitchen, scullery, family, dining, alfresco entertaining, pool, over sized double garage + store, drive thru access, triple driveway, solar panels ++ all on a rare 540 m2 block

FEATURES YOU WILL LOVE

- Stunning street appeal with stone cladding to front entrance
- Wide triple driveway + high clearance garage
- Artificial lawn and immaculate manicured gardens

Building Size : 297.131 sqm

Land Size : 540 sqm

View : <https://www.abelproperty.com.au/8005760>



Carolyn May
08 9208 1999

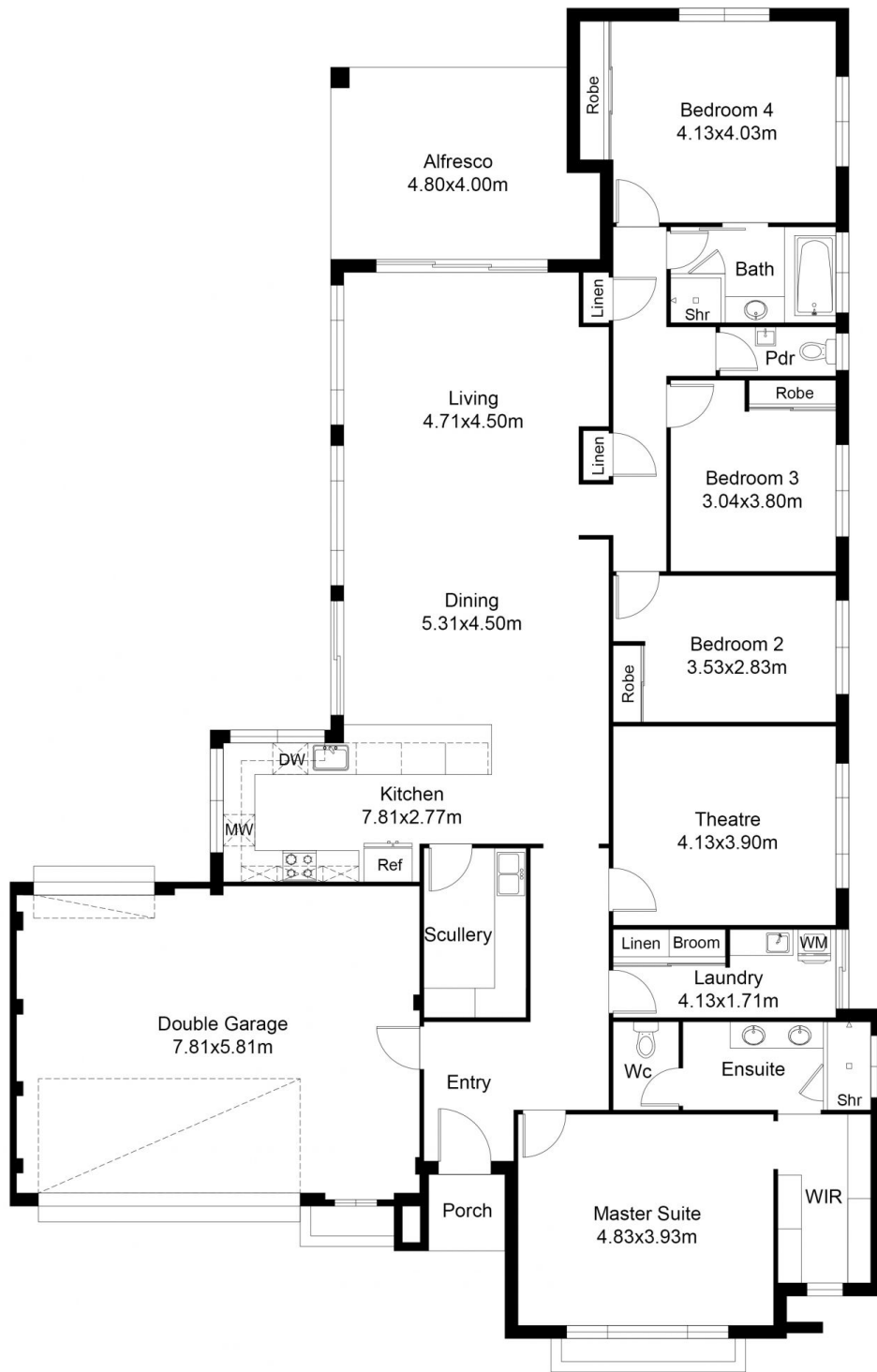

FLOOR PLAN

This floor plan including furniture, fixture measurements and dimensions are approximate and for illustrative purposes only. BoxBrownie.com gives no guarantee, warranty or representation as to the accuracy and layout. All enquiries must be directed to the agent, vendor or party representing this floor plan.

Residence	225.604 m ²
Alfresco	20.286 m ²
Garage	48.595 m ²
Porch	2.646 m ²
Total	297.131 m ²

11 Welford Street Aveley