



1/5 Anstey Street Claremont WA

3 3 2

YOUR HOME

Welcome to the Jewel in the 'Breckenridge' Crown! Ideally positioned offering expansive tree-lined street frontage on a generous exclusive use lot of approximately 340sqm land, this part two-level home is a rare find for downsizers, professional couples, singles, families looking for a low maintenance lifestyle, astute investors or country buyers seeking the ultimate Perth base. Bathed in northern light this stylish and spacious home is central to so much.

The huge main living area at the front of the home commands a soothing light and bright feel throughout and seamlessly connects to the front sundrenched north facing courtyard through sliding doors. This is the perfect environment to enjoy a barbecue or quiet drink whilst embracing the clear blue waters of the swimming pool and lovely leafy back drop.

Land Size : 340 sqm

View : <https://www.abelproperty.com.au/8005748>



Cam McGregor
08 9208 1999



Nathan McIntosh
(08) 9208 1999

Approximate Areas:

Ground Floor 123 m²
 First Floor 47 m²
 Balcony 8 m²

Total 178 m²

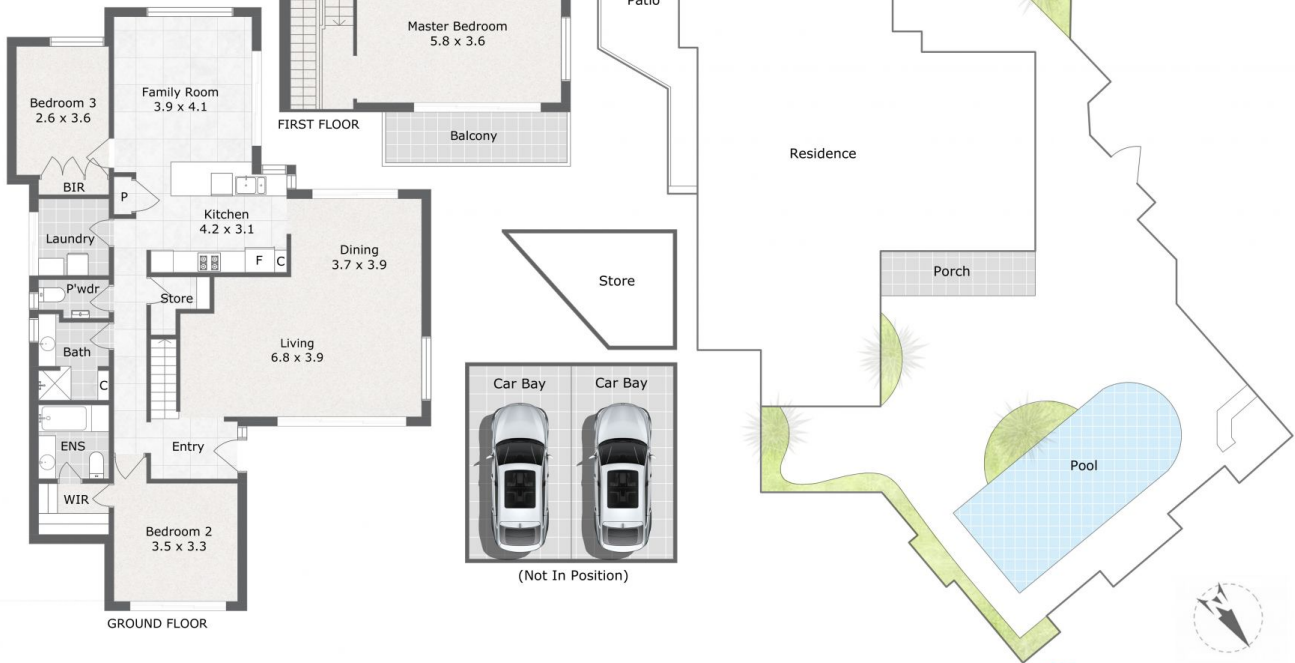

1/5 Anstey Street, Claremont WA 6010

VIS CREATIVE GROUP

Care has been taken to ensure the accuracy of this floor/site plan, however all dimensions and areas should be considered as approximate. It has been produced as a guide for the purpose of the property sale or lease only. No credit is taken for the original building or landscape design. This floor plan/site plan design is subject to strict copyright and should not be reproduced, copied or altered without prior consent. The Agent, Vendor & VIS Creative Group will not be held liable or responsible for any error, omission, misstatement or use of any data shown on this plan.