



### 127A Herbert Street Doubleview WA

3 2 2

Freshly painted throughout (inside & out!), with all new light fittings and crisp new lawn, this beautiful street front home is immaculately presented and awaiting its lucky new owners.

The modern, inviting façade welcomes you home with green reticulated lawns and easy-care garden beds.

Internally you'll love the blackbutt timber floors throughout the living zones, creating a warm & comfortable space to enjoy. The open plan kitchen, living & dining area enjoys plenty of natural light through the large windows and leads directly onto your alfresco for easy entertaining.

**Type** : House  
**Building Size** : 179 sqm  
**Land Size** : 320 sqm  
**View** : <https://www.abelproperty.com.au/8005720>



**Adrian Abel**  
08 9208 1999



**Jenna Abel**  
08 9208 1999

[For full version visit the website](https://www.abelproperty.com.au)

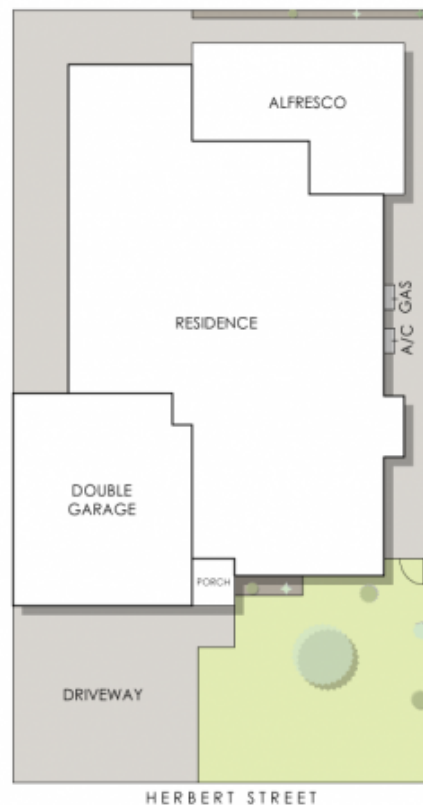

## 127A Herbert Street, Doubleview

Internal 115m<sup>2</sup> | External 27m<sup>2</sup> | Garage 37m<sup>2</sup> | Total Area 179m<sup>2</sup>



This floorplan is for illustration purposes only to show the layout of the property. Whilst every effort has been made to ensure the accuracy of the floor plan, all measurements, and any other information shown are of approximate dimensions only. Measurements and floor plans do not include or account for wall thickness or roof area under eaves. CMC Creative will not be held liable or responsible for any errors, omissions, misrepresentation or use of any information shown on the floor plan. Not to be used for any other purpose. [www.cmccreative.co.uk](http://www.cmccreative.co.uk)