



## 13A/28 Robinsons Avenue Perth WA

2 1 1

Conveniently located on the city fringes, yet nestled away from the hustle, bustle & noise - you'll love residing on Robinson Ave.

Beautifully renovated with a light, bright & neutral palette - 13A patiently awaits it's new owner to put their stamp on this stunning 2 bedder.

Open plan kitchen, dining & living means the layout is up to you - create an office nook, dine by the balcony or have an epic home theatre.

Both bedrooms are surprisingly spacious, the master with a built-in, and both are serviced by the modern bathroom. The European laundry means you can easily tuck your

**Type** : Apartment  
**Building Size** : 103 sqm  
**View** : <https://www.abelproperty.com.au/8005719>



**Jenna Abel**  
08 9208 1999



**Adrian Abel**  
08 9208 1999

[For full version visit the website](https://www.abelproperty.com.au)

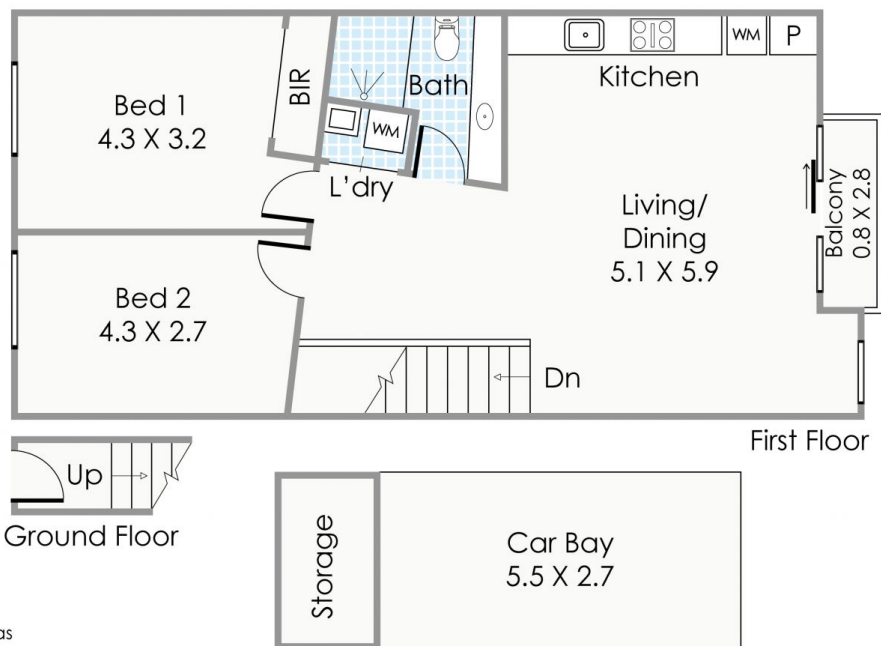

#### Approximate Areas

Residence:	79m <sup>2</sup>
Car Bay:	15m <sup>2</sup>
Balcony:	2m <sup>2</sup>
Stairwell:	3m <sup>2</sup>
Storage:	4m <sup>2</sup>

(Not Actual Location)



Total Area: 103m<sup>2</sup>

**abelproperty**

This floorplan is for illustration purposes only to show the layout of the property. Whilst every effort has been made to ensure the accuracy of this floor plan, all measurements, and any other information shown are an approximate interpretation only. Measurements and total areas do not include or account for wall thickness or roof area under eaves. Crib Creative will not be held liable or responsible for any error, omission, misrepresentation or use of any information shown on the final floor plan. Not to be used for any other purpose.  
www.cribcreative.com.au



**13A/28 Robinson Avenue, Perth**