



**15/303 Harborne Street Glendalough WA**

2 1 1

Conveniently located in a quiet pocket of Glendalough, this spacious 2-bedroom apartment awaits its new owners - and what an opportunity this presents!!!

Just a "hop skip & jump away" from the Glendalough Open Space, Herdsman Lake Regional Park to the west, and Lake Monger to the south-east, you'll have your choice of parklands to unwind, as well as access to a range of nearby amenities.

The property features:

- Nicely renovated kitchen completed with dishwasher, electrical oven and gas stove, flowing into the living/ dining area and good size balcony.

[For full version visit the website](https://www.abelproperty.com.au/7985385)

**Type** : Unit

**View** : <https://www.abelproperty.com.au/7985385>



**Dalila Pidone**  
**08 9208 1999**

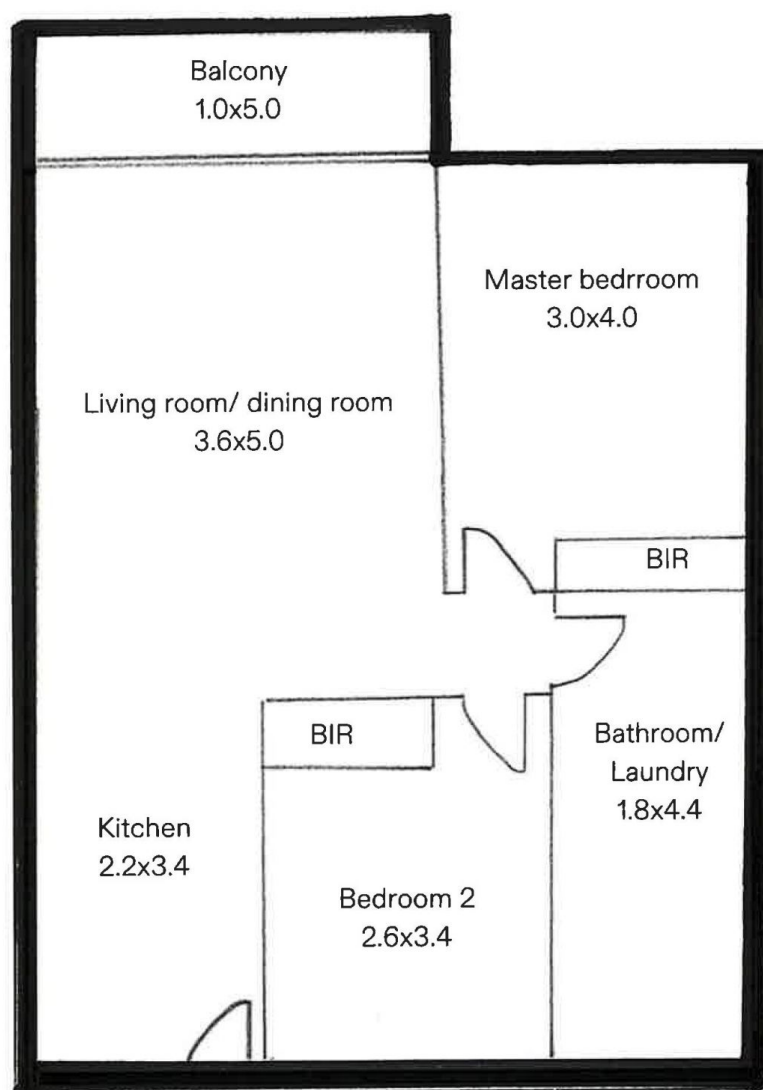

**Abelproperty**