



4/65 Beatrice Street Innaloo WA

2 2 1

Discover the epitome of contemporary living at this stunning 2 bedroom, 2 bathroom apartment perched on the upper level. Tucked away behind remote-controlled security gates within one of Innaloo's most impeccably maintained complexes, this residence offers a fusion of style and low maintenance convenience.

Step inside to find a luminous open-plan layout where sleek timber floorboards pave the way for seamless living, dining, and kitchen areas. Adorned with gleaming stone benchtops, glass splashbacks, and top-of-the-line European appliances, the kitchen exudes modern elegance. A spacious front balcony beckons for outdoor gatherings, boasting a desirable north-facing aspect.

Type : Apartment
Land Size : 108 sqm
View : <https://www.abelproperty.com.au/7967995>



Deirdre McTiernan
08 9208 1999

[For full version visit the website](https://www.abelproperty.com.au)

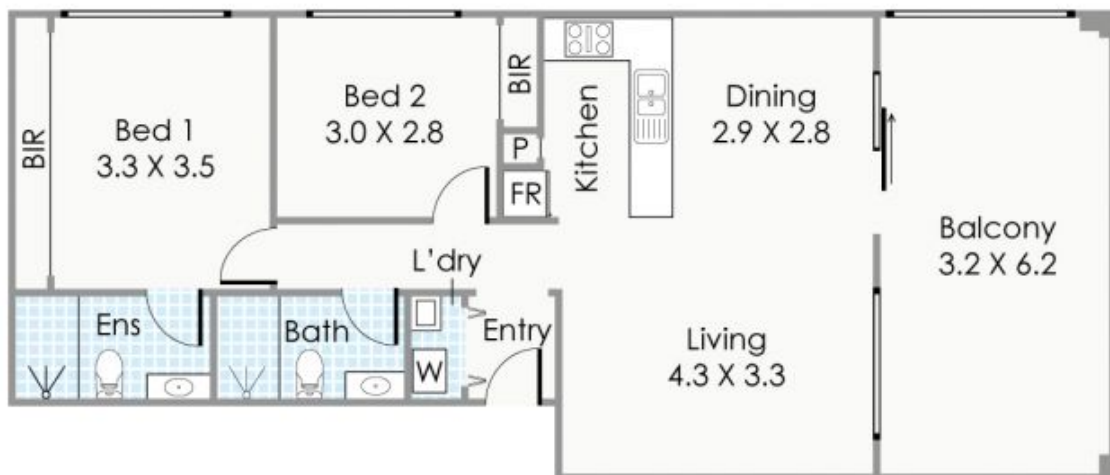

(Not Actual Position)

Approximate Areas

Residence:	67m ²
Balcony:	21m ²
Store Room:	4m ²
Carbay:	16m ²
Total Area:	108m ²



This floorplan is for illustration purposes only to show the layout of the property. Not to be used for any other purpose. www.cribcreative.com.au



4/65 Beatrice Street, Innaloo